



# STREET ADDRESSES

## WILSKY AT WATERS OFFICES

**SEC 23 TWP 28 RNG 17**

**ADDRESSES ISSUED ON 3/4/2005**

**FOLIO # 4445.7152**

**TAMPA 33615**

SPACE ##	ADDRESS
1	8414 WILSKY BLVD.
2	8412 WILSKY BLVD.
3	8410 WILSKY BLVD.
4	8408 WILSKY BLVD.
5	8406 WILSKY BLVD.
6	8404 WILSKY BLVD.

**\*NOTE\* WHEN COMBINING SPACES, THE ADDRESS WILL BE DETERMINED BY THE LOCATION OF THE FRONT DOOR.**

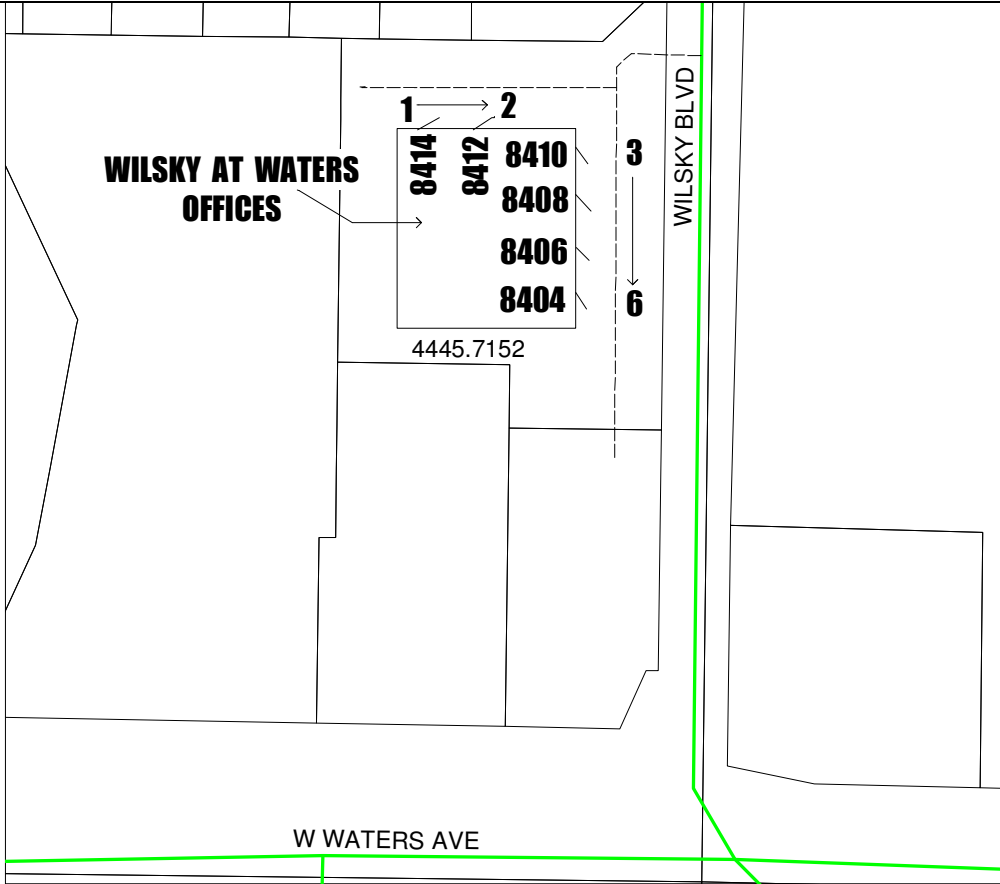

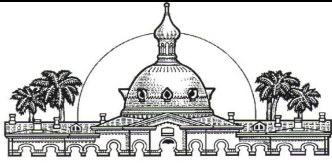

Hillsborough  
County

**OFFICE OF PUBLIC SAFETY  
911 AGENCY  
STREETS AND ADDRESSES UNIT**

**PROFESSIONAL OFFICE BUILDING**

(FKA 7751 W. WATERS AVE.)

(LOT 3 OF WATERS & WILSKY PLATTED SUBDIVISION PB 91 PG 32)

SEC 23 TWP 28 RNG 17

ADDRESSES ISSUED ON 1/31/2011

FOLIO # 004445.7156

TAMPA 33615

SPACE #	ADDRESS
1	7759 W. WATERS AVE.
2	7757 W. WATERS AVE.
3	7755 W. WATERS AVE.
4	7753 W. WATERS AVE.

**\*NOTE\***

**WHEN COMBINING 2 OR MORE SPACES, THE ADDRESS WILL  
DETERMINED BY THE LOCATION OF THE FRONT DOOR.**

